

WWW.PULTE.COM

WINTER HEIGHTS

PURCHASER(S) _____ DATE _____

DATE _____

AUTHORIZED AGENT _____ DATE _____

PREPARED BY: _____

SALES REPRESENTATIVE _____ DATE _____

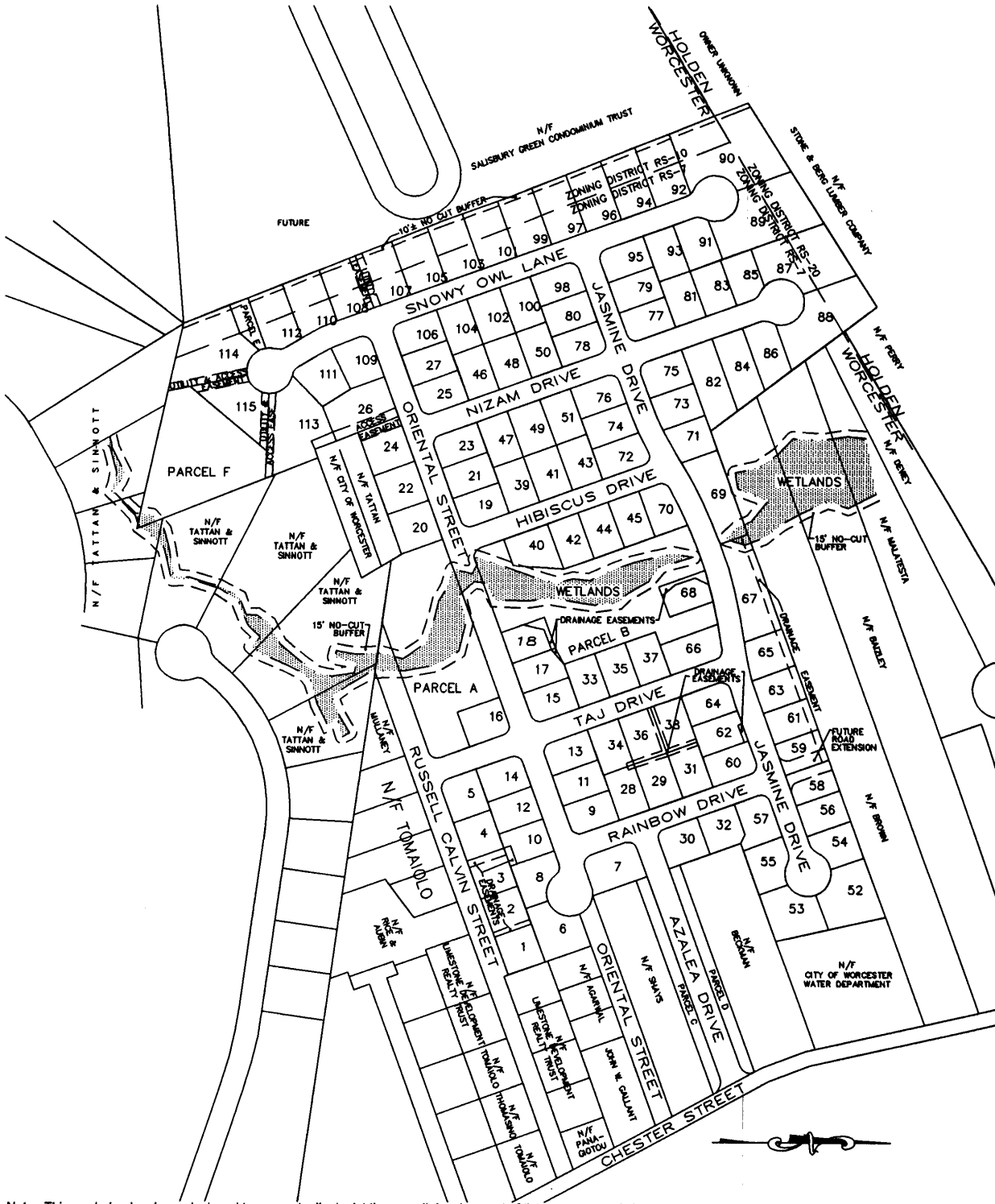

Note: This rendering has been designed to conceptually depict the overall development of the property and is believed to be accurate as of its date of preparation. When constructed, individual features of the site including but not limited to walks, landscaping, adjacent land uses, disturbed areas, location of storm water management and sediment control facilities and amenities may vary from this rendering.

Individual house siting and style of architecture of the individual homes may also change at the sole discretion of Pulte Home Corporation at any time prior to construction. This rendering is not intended to create any express or implied warranty that the improvements to be constructed will conform to the aforementioned features, house siting, or style of architecture shown.

Street lights, mailboxes, electrical transformers, telephone pedestals, and refuse collection areas will be installed in various locations within this project. Locations vary due to the existence of other improvements; therefore, they are not depicted here.

All lots are subject to telephone, electric and cable television easements. Exact locations are to be determined by the utility companies.